

SGF98 GRAVITY FEED SPRAY GUN

SHARPE
THE SPRAY GUN PEOPLE
FOR PRODUCT INFORMATION CALL:
1 (800) SHARPE 1

SGF98 GRAVITY FEED SPRAY GUN has been designed for the Professional Painter. Sharpe has perfected the European style of refinishing while affording the painter total control of all elements of painting: pattern size, pattern shape, fluid delivery and atomization.

SGF98 HVLP SPRAY GUN KIT

Includes:

SGF98 GRAVITY FEED SPRAY GUN

- Engineered and manufactured using the latest technology
- Rugged design for everyday use
- Larger uniform spray pattern
- FULL RANGE of air cap and fluid tip combinations
- Designed for today's complex refinish systems
- Completely gun washer safe

NYLON OR ALUMINUM CUP

565GC NYLON GRAVITY CUP

- "NO DRIP" feature in cup lid prevents leaks and spills
- 22 oz. capacity

650GC ALUMINUM GRAVITY CUP

- "NO DRIP" feature in cup lid prevents leaks and spills
- 23 oz. capacity



PREFERRED BY THE PROFESSIONAL

- For compliant spraying, SHARPE SGF98-HVLP Gravity Feed Spray Gun meets all Environmental Regulations governing HVLP equipment
- Famous SHARPE quality backed by our two-

"From the Advanced Technology Division of Sharpe"

SHARPE MANUFACTURING COMPANY: 8750 Pioneer Boulevard, Santa Fe Springs, CA 90670
(562) 908-6800, www.sharpe1.com
309988B, 1/2004

SGF98 GRAVITY FEED SPRAY GUN

SGF98 CLEANING

1. Empty the gravity feed cup of material and replace with a suitable solvent.
2. Operate the trigger until all traces of material have disappeared and the fluid passages are thoroughly clean.
3. Wipe the exterior of the gun with a solvent dampened cloth.

Note: Never submerge complete spray gun in any cleaning solution.

Never use any hard objects, such as wire, paper clip, or welding tip cleaner, to clean the air cap orifices. The air cap is made of high alloy heat treated aluminum and hard objects will damage the orifices. To clean the air cap, soak it in a compatible cleaning solution and use soft objects, such as a medium bristle brush.

SGF98 PREVENTIVE MAINTENANCE

1. The spray gun should be lubricated frequently, using a non-silicone oil. Place a drop on all moving parts.

Specifically:

- On the shank of the fluid needle assembly where it enters packing nut.
- On trigger shaft (both sides).
- On exposed portion of air valve.



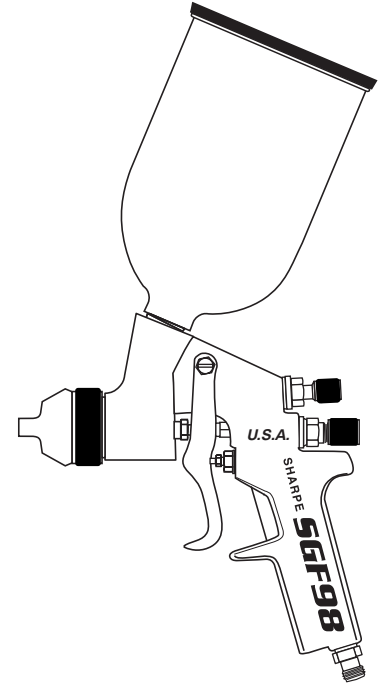

2. Do not completely disassemble the Spray Gun if poor spray pattern occurs. See trouble shooting section below for information on how to correct problem.

Note: Do not overfill gravity feed cup with material. Be certain to always keep cup lid vent hole clear.

WARNING: Never pull trigger on Spray Gun when pointed in the direction of your face, eyes or body.



TROUBLE SHOOTING SPRAY GUN TEST PATTERNS

CONDITION	CAUSE	CORRECTION	CONDITION	CAUSE	CORRECTION
 RIGHT	Correct Normal Pattern	No correction necessary.	 WRONG	Dirty or distorted air horn holes.	Rotate air cap 180°. If pattern follows air cap, problem is in air cap. Clean and inspect the horn holes. If horn holes are distorted, replacement is necessary.
 WRONG Heavy Top or Bottom Pattern	1. Dirty or damaged air cap. 2. Dirty or damaged fluid tip.	Rotate air cap 180°. <ol style="list-style-type: none"> a. If pattern follows air cap, problem is in air cap. Clean and inspect. If pattern is not corrected, replacement is necessary. b. If pattern does not follow the air cap, the problem is with the fluid tip. Clean and inspect the tip for dried paint, dirt or damage. If the pattern is not corrected, replacement is necessary. 	 WRONG Gun Spitting	Air getting into paint stream somewhere. EXAMPLE: Same symptoms as a cup running out of paint.	1. Check and tighten fluid needle packing nut. 2. Tighten fluid tip. 3. Check fluid tip seat for damage. 4. Check for poor gun to cup seating.
 WRONG Split Pattern	Pressure too high for material viscosity being sprayed.	1. Reduce air pressure, increase fluid pressure. 2. Increase material viscosity. 3. Pattern may also be corrected by narrowing fan size with spray width adjuster control knob.	Air back pressuring into cup.	Excessive air blowing back into cup.	1. Tighten fluid tip. 2. Check fluid tip seat. 3. Check for damaged fluid seat on tip or seat on gun head.

SGF98 GRAVITY FEED SPRAY GUN

PARTS LIST SGF98 GRAVITY FEED SPRAY GUN KIT

Part No.	Comp. No.	Description	Part No.	Comp. No.	Description
1-20-28	10326	Head Attachment Gasket	1-PLT-11A	34940	Packing
1-555-19	21719	Cup Filter	1-PLT-11b	34941	Packing Seal
1-565-04	21795	Lid for Nylon Cup	1-PLT-29	34954	HVLP Gun Head
1-650-04	22104	Lid for Aluminum Cup	1-PLT-33	34960	Spring Washers (2)
1-650-07	22107	Gasket	1-PLT-35	34962	Trigger Screw
1-650-78	22178	"No Drip" Cap Assy.	1-SGF-46	37046	Width Control Bushing
1-71-25	16151	Air Valve Cage	1-SGF-65	37065	Gun Washer Adapter
1-71-27	16153	Head Attaching Screw	1-SGF98-01	38001	Tip Gasket
1-71-37	16162	Air Valve Packing	1-SGF98-02	See Combination Chart	Air Cap
1-71-38	16163	Gasket (two)	1-SGF98-03	See Combination Chart	Fluid Needle Assembly
1-71-42	16167	Air Valve Spring	1-SGF98-05	See Combination Chart	HVLP Fluid Tip & Fluid Needle Matched Set
1-71-50	16175	"E" Clip	1-SGF98-08	38108	Width Control Assembly
1-775-41X	25066	Air Valve	1-SGF98-13	38120	O-Ring
1-971-06	U26016	Air Valve Assembly	1-SGF98-24	38124	Fluid Needle Spring
1-971-21	26032	Packing Nut (two)	1-SGF98-26	38126	Gun Handle
1-971-32	26042	Trigger	1-SGF98HVLP-26	38130	HVLP Gun Handle
1-971-34	U26044	Trigger Shaft	1-SGF98-29	38129	Gun Head
1-971-44	26054	Plug	1-SGF98-55X	38155	Width Control Knob & Valve
1-971-45	26055	Air Inlet Nipple	1-SGF98-RK	38160	Service Kit
1-971-56	U26066	Spray Width Adj. Body	565GC	6678	Nylon Cup Assembly
1-975-54	27060	Material Control Knob	650GC	6685	Aluminum Gravity Cup
1-998-04	See Combination Chart	Fluid Tip-Niflor®			

COMBINATION CHART FOR MODEL SGF98HVLP SPRAY GUNS

SPRAY GUN WITH NYLON CUP	SPRAY GUN WITH ALUMINUM CUP	AIR CAP	FLUID TIP & NEEDLE MATCHED SET	AIR CONSUMPTION INLET PRESSURE AIR CAP PRESSURE	REMARKS
(1.0 mm) SGF98-HVLP-1.0 Comp. #5910	(1.0 mm) SGF98-HVLP-1.0 Comp. #5910A	1-SGF98-02#1.0 Comp. #38010	1-SGF98-05-1.1 Comp. #38111	12.9 CFM 43 PSI 8 PSI	Small Areas Very Fine Atomization
(1.3 mm) SGF98-HVLP-1.3 Comp. #5913	(1.3 mm) SGF98-HVLP-1.3 Comp. #5913A	1-SGF98-02#1.3 Comp. #38013	1-SGF98-05-1.3 Comp. #38113	12.9 CFM 43 PSI 8 PSI	High Solids Colors and Clears
(1.5 mm) SGF98-HVLP-1.5 Comp. #5915	(1.5 mm) SGF98-HVLP-1.5 Comp. #5915A	1-SGF98-02#1.5 Comp. #38015	1-SGF98-05-1.5 Comp. #38115	12.9 CFM 43 PSI 8 PSI	High Solids Colors and Clears
(1.7 mm) SGF98-HVLP-1.7 Comp. #5917	(1.7 mm) SGF98-HVLP-1.7 Comp. #5917A	1-SGF98-02#1.7 Comp. #38017	1-SGF98-05-1.7 Comp. #38117	12.9 CFM 43 PSI 8 PSI	High Viscosity Materials Including Enamels

COMBINATION CHART FOR MODEL SGF98 SPRAY GUNS

MODELS AVAILABLE	AIR CAP	FLUID TIP	FLUID NEEDLE	AIR CONSUMPTION	REMARKS
(1.4 mm) SGF98-GP-55 Comp. #5885	1-SGF98-02#GP Comp. #38002	(.055) 1-998-04-55NI Comp. #27255	1-SGF98-03-45N Comp. #38023	11.0 CFM @ 50 PSI	All Automotive Colors and Clears
(1.2 mm) SGF98-A-45 Comp. #5890	1-SGF98-02#A Comp. #38004	(.045) 1-998-04-45NI Comp. #27245	1-SGF98-03-45N Comp. #38023	13.8 CFM @ 50 PSI	High Solids Colors and Clears
(1.2 mm) SGF98-C-45 Comp. #5895	1-SGF98-02#C Comp. #38006	(.045) 1-998-04-45NI Comp. #27245	1-SGF98-03-45N Comp. #38023	13.8 CFM @ 50 PSI	High Solids Clears

Call Customer Service @ 1-800-SHARPE1 or visit our website @ www.sharpe1.com
for SHARPE'S HVLP Spray Gun recommendations for specific paint company products
SHARPE MANUFACTURING COMPANY • 8750 Pioneer Boulevard, Santa Fe Springs, CA 90670
(562) 908-6800 • FAX (562) 908-6899

SHARPE SGF98

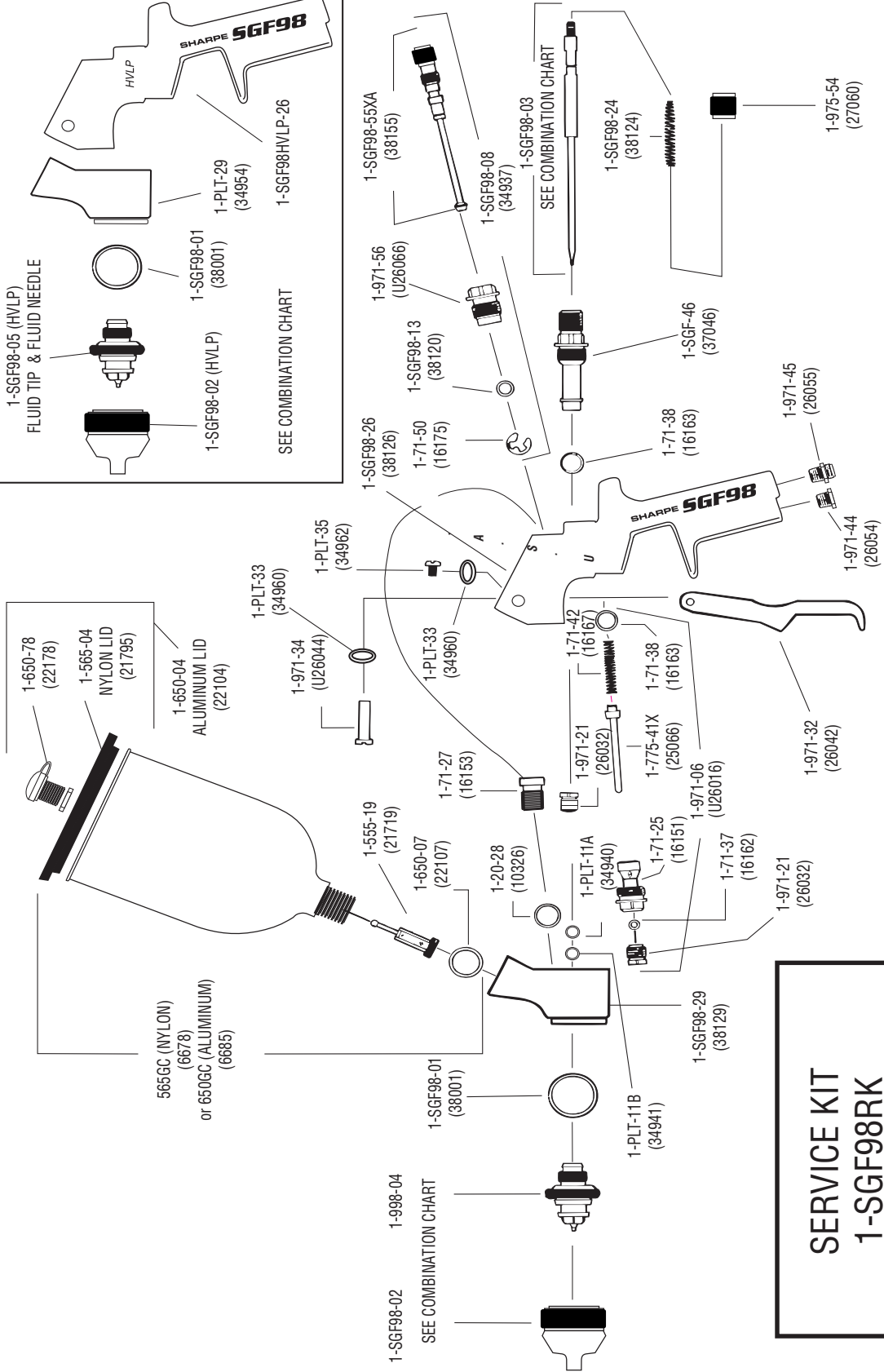
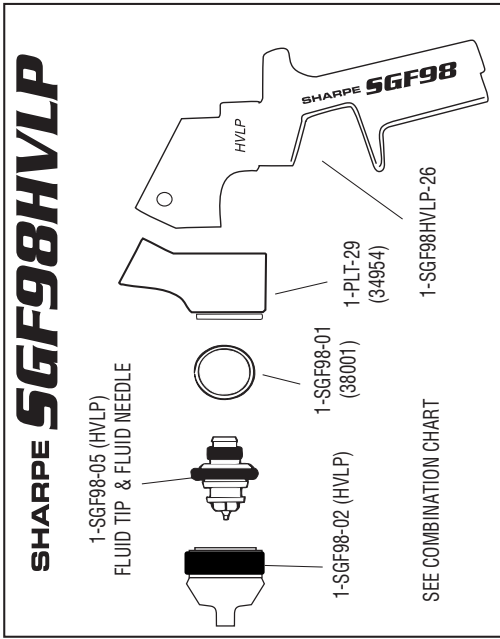

SERVICE KIT
1-SGF98RK
(COMP. NO. 38160)